

MULTIPLE FUNCTIONS
IN A MINIMUM OF
SPACE

Wired Motion Detector for 55mm frames – indoor

HmIPW-SMI55

The compact motion detector with high-performance PIR sensor includes three functions in one device: Precise detection of movements for automatic switching of lights offers secure monitoring of rooms. At the same time, the device offers manual control of Homematic IP devices and functions via two push-buttons.



homematic ^{IP}
wired

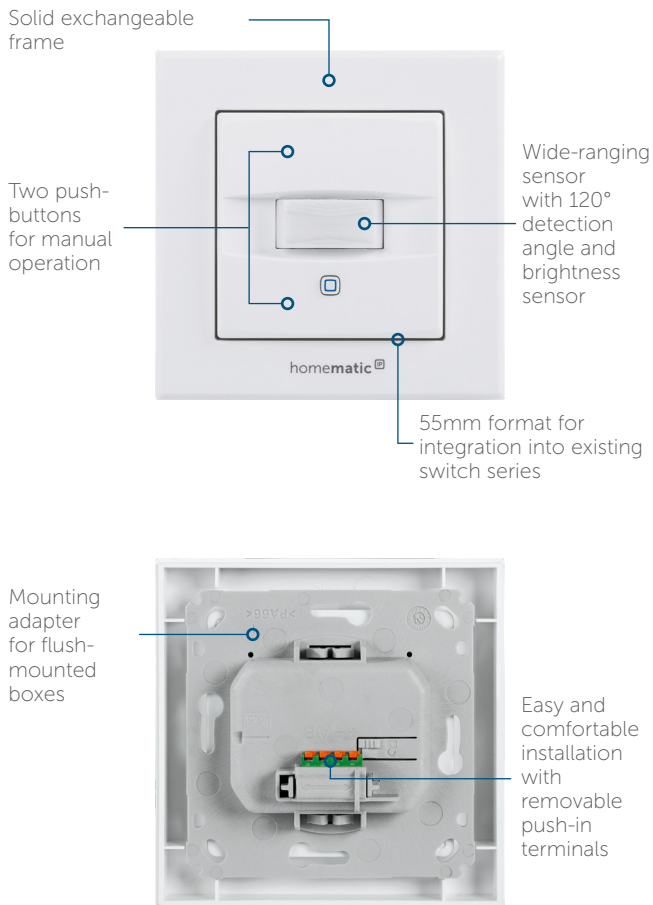

ALL-IN-ONE: MOTION DETECTOR AND SWITCH

Detects movements and ambient brightness for intelligent monitoring of rooms. Two push-buttons for manual control of devices or system functions, independent of motion detection.

INCREASED COMFORT AND SECURITY

Automatic light control when motion is detected. Depending on the brightness in the room, the light is switched on only when it is needed, for greater convenience and energy savings. Monitoring of rooms offers increased security in smart homes.

POWER SUPPLY VIA THE WIRED BUS

Connection is established via the wired bus for reliable power supply and secure communication between the devices.

EASY INTEGRATION INTO EXISTING DESIGN

Easy to integrate into existing switches with 55 mm frames of the following manufacturers: e.g. Berker, Busch-Jaeger, GIRA, Merten, JUNG, Kopp and ELSO

FIRM HOLD ON FLUSH-MOUNTED BOXES

Optimised for flexible and easy installation on flush-mounted boxes via a mounting plate and removable push-in terminal for connection to the wired bus.

The wired system can be controlled via the CCU3 Central Control Unit, various partner solutions and, in future, via the Homematic IP Access Point.

- For operation of the wired system, the Homematic IP Wired Access Point is required.

TECHNICAL SPECIFICATIONS

Supply voltage	24 VDC, +5 % -20 %, SELV
Current consumption	5 mA max.
Standby power consumption	60 mW
Installation	only in normal commercial switch boxes (device boxes) in accordance with DIN 49073-1
Cable type and cross section	rigid cable, 0.12-0.50 mm ²
Degree of protection	IP20
Ambient temperature	-5 to +40 °C
Dimensions (W x H x D)	
Without frame	71 x 71 x 40 mm
Including frame	86 x 86 x 40 mm
Weight	75 g
Detection range	12 m
Detection angle horizontal	120°
Detection angle vertical	-10° to +25°

LOGISTICAL DATA

Product reference	153751A0
EAN code	4047976537518
Short description	HmIPW-SMI55
Packing unit	60
Packing dimensions	122 x 112 x 73 mm
Weight incl. packaging	193.5 g

PACKAGE CONTENTS

Homematic IP Wired Motion Detector for 55mm frames – indoor
Clip-on frame and mounting plate
Screws (4x)
User manual